



MARINE ENGINES & COMPONENTS

DETERMING ENGINE ROTATION

courtesy of



ENGINE ROTATION

Engine rotation is viewed from the flywheel of the engine, counter clockwise would be left hand, & clockwise would be right hand



If your FLYWHEEL turns counter clockwise you have LEFT HAND engine rotation

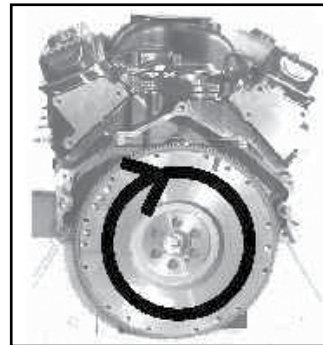

If your FLYWHEEL turns clockwise you have RIGHT HAND engine rotation

If you can not view the engine from the flywheel end, look at the belts & pulleys and refer to the diagram below, propeller rotation is not a good indication of engine rotation, a drive or transmission can reverse engine rotation, ALL I/O ENGINES ARE LEFT HAND!

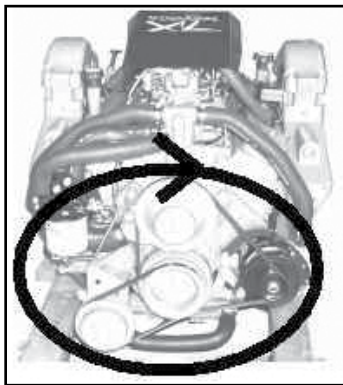

If your BELTS & PULLEYS turn clockwise you have LEFT HAND engine rotation

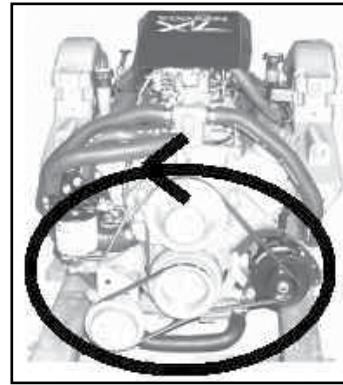

If your BELTS & PULLEYS turn counter clockwise you have right hand engine rotation

MARINE ENGINES & COMPONENTS

NEW & REMANUFACTURED LONG BLOCKS



NEW GM 5.7, V8 VORTEC BASE ENGINES

"BREATH LIFE BACK INTO YOUR VESSEL"



5.7L GM marine vortec base engine, includes 4 bbl Holley carburetor, Mallory electronic ignition, spark plugs & wires, electric fuel pump with safety switch, oil pan, circulating pump, flywheel, harmonic balancer, limited 1 year warranty

- REPLACEMENTS FOR MERCUISER, VOLVO-PENTA, OMC, STERNDRIVES, & CRUSADER INBOARD APPLICATIONS -

STERNDRIIVE PART#:
CRU-BASE-LH-IO

INBOARD PART#:
CRU-BASE-LH-IB
CRU-BASE-RH-IB

Displacement: 5.7L / 350 CID
Cylinders: V8
Block Mfg.: GM Powertrain
Fuel Required: Unleaded, 89 Octane Min.
Horsepower: 310 hp @ 5000 rpm's (Carb.)
Oil Type: (SAE 15W-40)
Warranty: 12 Month Limited

BARR
MARINE BY EDM

NEW 3.0L GM SERVICE REPLACEMENT ENGINE



Part#
BAR-3.0L

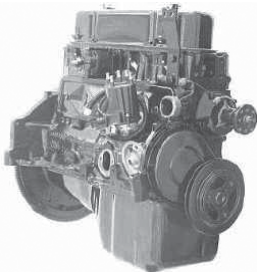

Displacement: 3.0L / 181 C.I.D.
Cylinders: In-Line 4 Cylinder
Bore & Stroke: 4.00 x 3.30
Comp. Ratio: 9.25 : 1 High Flow Vortec H
Block Mfg.: GM Powertrain
Fuel Required: Unleaded, 89 Octane Min.
Horsepower: 140 hp @ 4800 rpm (Carb.)
Oil Type: SAE 15W40 Pennzoil Marine
Warranty: 12 Month Limited

includes oil pan, valve covers, harmonic balancer, circulating pump, & electronic distributor

BARR
MARINE BY EDM

NEW 4.3L GM SERVICE REPLACEMENT ENGINE



Part#
BAR-4.3L

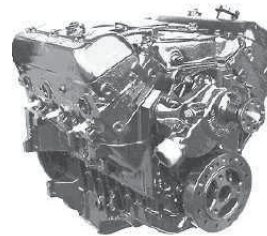

Displacement: 4.3L / 229 C.I.D.
Cylinders: V6
Bore & Stroke: 4.00 x 3.48 Inches
Comp. Ratio: 9.4 : 1
Block Mfg.: GM Powertrain
Fuel Required: Unleaded, 89 Octane Min.
Horsepower: 223 hp @ 4800 rpm (Carb.)
Oil Capacity: 4.5 QT
Warranty: 12 Month Limited

includes water circulating pump, spark plugs, flywheel, cast iron intake (2bbl), oil pan, valve covers, & harmonic balancer

FIRST MATE

FIRST MATE PERFORMANCE "BLUEPRINT" MARINE ENGINES

4.3 Liter GM 262 PERFORMANCE BASE ENGINE



HEADS: Cast Iron Vortec
CRANK: Cast Iron Premium
PISTONS: Hypereutectic
INTAKE: Cast Iron
CAMSHAFT: Flat tappet

.457 intake and exhaust lift, 218 intake and exhaust duration at .050

PEAK HP 262 PEAK TORQUE 300ft/lbs

Part#
FIRMBP262CT

5.7 Liter GM 350 "Stroker" 383 BASE ENGINE



HEADS: Cast Iron Vortec
CRANK: New SCAT Cast Iron
PISTONS: Hypereutectic
INTAKE: Cast Iron
CAMSHAFT: Roller tappet

.503 intake .510 exhaust lift, 224 intake 230 exhaust duration at .050

PEAK HP 405 PEAK TORQUE 450ft/lbs

Part#
FIRMBP3830CT



MARINE ENGINES & COMPONENTS

REMANUFACTURED MARINE CYLINDER HEADS

FIRST MATE REMANUFACTURED MARINE CYLINDER HEADS

These remanufactured heads feature New valve springs, Thre angle valve job, high quality silicone seals, all guides replaced, baked, cleaned then shot blasted, & 100% magnetic particle inspection. They are sold on an outright basis & NO core return necessary

“NEW”

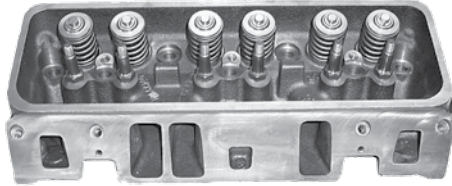

Part#
MCHCHE817N GENERAL MOTORS (350)

Description:
5.7L, Vortec head, heart shaped chambers, rocker bolts in center of head, has 4 intake bolts per side, 260hp, 8 cyl.
Casting Numbers: 906, 062

“NEW”

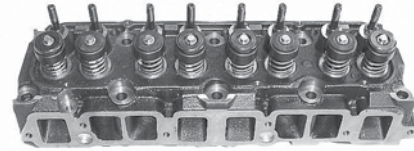

Part#
18-4489 GENERAL MOTORS (151 / 183)

Description:
2.5L & 181 cu.in. 3.0L Mercruiser, OMC, & others, 1968 thru 1995 NON vortec
Casting Numbers: 954, 748, 950, 758, 087, 852, 531
Note: Engines between 1968-1982 use manifold to head gasket #CHV-47-0120, Engines between 1983-1995 use manifold to head gasket 18-1204

FIRST MATE

REBUILT



Part#
FIRH-6007 GENERAL MOTORS (250)

Description:
4.1L, tapered seat plugs, standard marine replacement, 150/165hp 6 cyl.
Casting Numbers: 763, 052

FIRST MATE

REBUILT

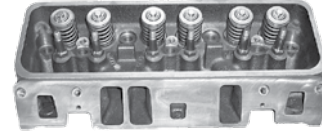

Part#
FIRH-6009 GENERAL MOTORS (262)

Description:
4.3L, 3 accessory mounting holes on the front of the head, substitute for the 2 accessory mounting holes on the front of the head, press in studs, 175/205hp, 6 cyl.
Casting Numbers: 768, 996, 107, 476, 103, 066

FIRST MATE

REBUILT

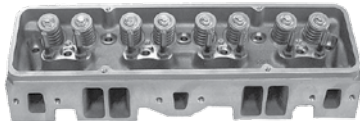

Part#
FIRH-6015 GENERAL MOTORS (305)

Description:
5.0L, Heavy casting, 6 bolt exhaust, early style, valve covers bolt around perimeter, 200/230hp, 8 cyl.
Casting Numbers: 434, 741

FIRST MATE

REBUILT

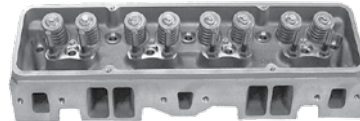

Part#
FIRH-6017 GENERAL MOTORS (305)

Description:
5.0L, Tall valve cover rail, valve cover bolts down center, NON vortec head, round push rod holes, Must use rail rockers, 200/230hp, 8 cyl.
Casting Numbers: 081

FIRST MATE

REBUILT

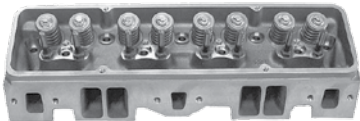

Part#
FIRH-6017A GENERAL MOTORS (305)

Description:
5.0L, Tall valve cover rail, valve cover bolts down center, NON vortec head, round push rod holes, Must use rail rockers, 200/230hp, 8 cyl.
Casting Numbers: 087

FIRST MATE

REBUILT

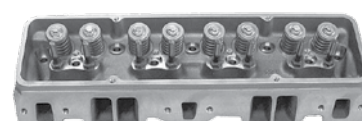

Part#
FIRH-6022 GENERAL MOTORS (350)

Description:
5.7L 1.9375 intake valves, taper plug, valve covers bolts around perimeter, with roto, 260hp, 8 cyl.
Casting Numbers: covers all early style that are not #882

MARINE ENGINES & COMPONENTS

REMANUFACTURED MARINE CYLINDER HEADS



FIRST MATE REMANUFACTURED MARINE CYLINDER HEADS

Call our sales dept. for instructions on locating your casting number to ensure correct replacement is ordered

FEATURES OF A FIRST MATE REBUILT MARINE HEAD

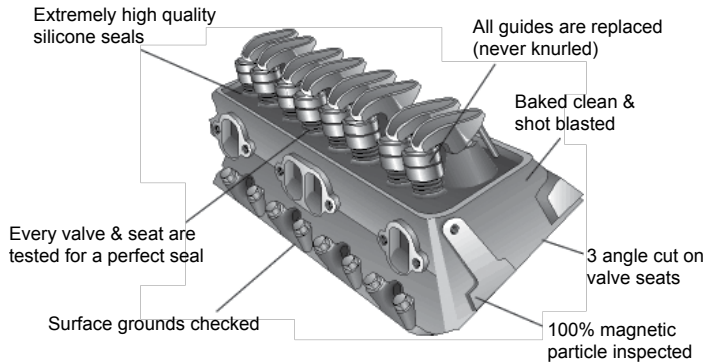

FIRST MATE

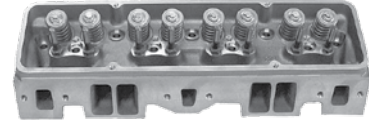

REBUILT

Part#

FIRH-6023 GENERAL MOTORS (350)

Description:

5.7L, Tall valve cover rail, NON vortec head, valve cover bolts down center of head, 1.940 intake, square intake ports, 260hp, 8 cyl.

Casting Numbers: 083, 193, 217

FIRST MATE

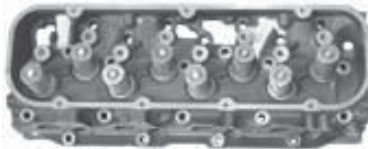

REBUILT

Part#

FIRH-6031 GENERAL MOTORS (454)

Description:

7.4L, Taper plug, small oval intake port head, with roto's, 330hp, 8 cyl.

Casting Numbers: 045, 360, 039, 416

FIRST MATE

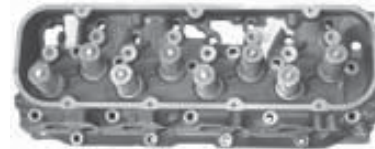

REBUILT

Part#

FIRH-6032 GENERAL MOTORS (454)

Description:

7.4L, Taper plug, large oval intake port head, with roto's, 330hp, 8 cyl.

Casting Numbers: 781, 049, 186

FIRST MATE

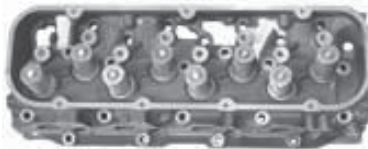

REBUILT

Part#

FIRH-6033 GENERAL MOTORS (454)

Description:

7.4L, Gen V head, standard marine replacement, 330hp, 8 cyl.

Casting Numbers: 156, 932

FIRST MATE



REBUILT

Part#

FIRH-6041A CHRYSLER (318)

Description:

5.2L, Standard chrysler replacement, with pad & W/O AIR, with roto's, 200hp, 8 cyl.

Casting Numbers: 973, 163, 593, 851, 585

FIRST MATE



REBUILT

Part#

FIRH-6045 CHRYSLER (360)

Description:

5.9L, Standard chrysler replacement, with pad & W/O AIR, with roto's, 200hp, 8 cyl.

Casting Numbers: 830, 496, 230, 915

FIRST MATE



REBUILT

Part#

FIRH-6051 MERCUISER (224)

Description:

3.7L, standard marine replacement, has outlet on end of head, 170/190hp, 4 cyl.

Casting Numbers: E6TE-DA, E8TE-DA, D3VE-A2A



MARINE ENGINES & COMPONENTS

MARINE INTAKE MANIFOLDS & TIMING COVERS

INTAKE MANIFOLD GM SB HI-RISE

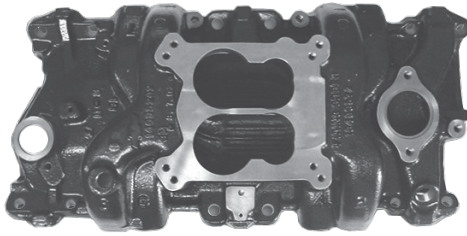

Part#
856076

Description:
Fits GM CHEVY SB (5.0 & 5.7L) engines with 12 bolt mounting pattern, (pre vortec) valve covers bolt down center, Casting #14096244

Part# **Description:**
BJM8504 Mounting bolt kit (12)

INTAKE MANIFOLD GM 454 7.4L (OVAL PORTS)

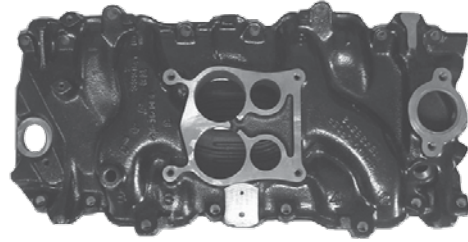

Part#
3854100

Description:
Fits GM CHEVY BB (454 7.4L) engines with oval ports & 4 BBL rochester carburetors, 16 bolt mounting pattern, Casting #333841

Part# **Description:**
EDL8564 Mounting bolt kit (16)

CAST IRON INTAKE MANIFOLD VORTEC GM CHEVY 5.0 & 5.7L

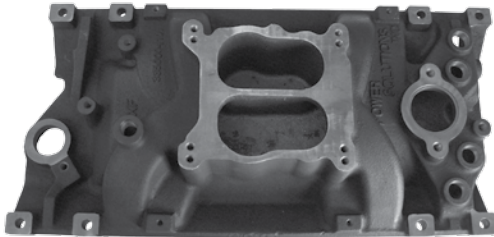

Part#
EGL6107

Description:
Fits GM CHEVY (5.7L V-8 VORTEC ENGINES), fits late model GM CHEVY (5.7L Engines), "E-COATED" for longer life, will accept 4-BBL Square Bore Carburetors such as Edelbrock and Holley

Part# **Description:**
EDL8516 Mounting bolt kit (8)

ALUMINUM INTAKE MANIFOLD VORTEC GM CHEVY 5.0 & 5.7L

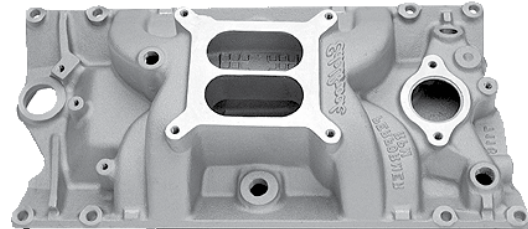

Part#
CRUR002018C

Description:
Aluminum with Bronze Inserts for GM (Chevy) 5.0 & 5.7L "Vortec" Engines, (8-bolt pattern to secure intake manifold to heads), will accept 4-BBL Square Bore Carburetors such as Edelbrock & Holley. Note: this intake manifold is made by Crusader & Pleasurecraft Marine (part # R002018C) has bronze cross over & bronze ring in thermostat housing

Part# **Description:**
EDL8516 Mounting bolt kit (8)

TIMING CASE COVERS

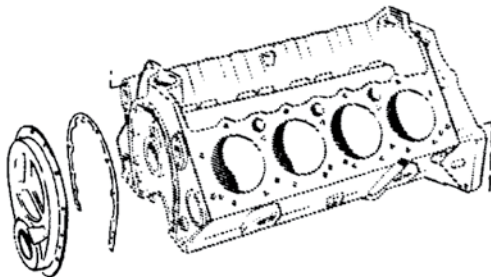

Part #	Description:
3853135	In-line 4 & 6 cylinder GM, w/ seal & timing tab, No gasket
18-0887	Cover gasket for In-line 4 & 6 cylinder cover (3853135)
BJM6544-K	V6 & V8 small block GM w/ cover gasket & bi-rotational seal
18-0976	Cover gasket for V6 & V8 SB (BJM6544-K)
66215	V8 GM big block w/ seal , No gasket
18-0980	Cover gasket for V8 BB cover (66215)
1697335	Front seal, V6 & V8 small block GM, Bi-rotational
268219471	Front seal, V8 bigl block GM, Bi-rotational
PNRS-1105	Timing cover bolt kit, All V6 & V8

MARINE ENGINES & COMPONENTS

VALVE COVERS, OIL CAPS, HEAD BOLTS & ACCESSORIES



VALVE COVER KIT SB GM

Part#
BAR55-6000

Description:
Valve cover fits 1987 & later GM SB V8's, bolts down center, includes valve covers, gaskets, & all hardware

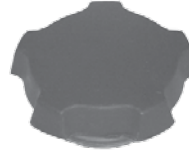

OIL CAP CLAMP STYLE

Part#
17345

Description:
Twist In type for 1-1/4" dia. hole



OIL CAP PUSH IN "BLANK"

Part#
BJM6539

Description:
Push in type for 1-1/4" dia. hole.



VALVE COVER 4.3L 1986 & UP

Part#
3854949 Port Side
3854948 Starboard Side

Description:
Valve cover fits GM 4.3L V6's



OIL CAP SCREW IN (PLASTIC)

Part#
3854008

Description:
For GM 1987 & up, will not rust

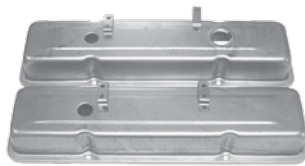

VALVE COVER BEFORE 1985

Part#
BJM6541 (pair)

Description:
Valve cover fits GM SB V8's prior to 1985, bolts around rim



Part#
97850

Description:
Breather, 1/2" hose barb

GROMMETS, & CONNECTORS

Part#
2552188 Grommet, Small Block GM
CRUR094016 Grommet, Big Block GM
CRU1104594 Connector, 45 degree
R035015 PCV Valve, 90 degree 3/8" hose
EEMFV156DP PCV Valve, straight 1/2" hose
EEMFV181DP PCV Valve, straight 3/8" hose

MERC 470/485 FRONT COVER

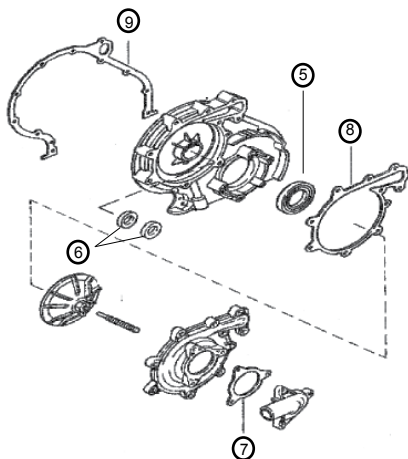

Part# **Description:**
18-4380 #7, 8, 9 Gasket Kit
18-0172 #6 Camshaft Seal (2)
2667388 #5 Crankshaft seal (1)
FM99087 Redi Sleeves for camshaft (2 required)



DOWEL PIN KITS - (HEAD TO BLOCK)

Part# **Description:**
PNRS-1110 Small Block GM V8
PNRS-1101 Big Block GM V8



HEAD BOLT KIT - 1 HEAD

Part#
MAL9-56501
Description:
V-8 Small Block GM (Chevy) Fits most 4.3, 5.0 and 5.7-Liter GM (Chevy) engines. Note: 1-kit secures 1-Head to 1985, bolts around rim



HEAD BOLT KIT - 1 HEAD

Part#
MAL9-56500
Description:
V-8 Big Block GM (Chevy) Fits most GM (Chevy) 454 cu.in. (7.4-liter) Big Block Cylinder Heads. Note: 1-kit secures 1-Head



HEAD BOLT WASHERS - 2 HEADS

Part#
MAL9-56551
Description:
Head Bolt Washers, 1-kit has enough washers for 2-heads



MARINE ENGINES & COMPONENTS

MARINE ENGINE OIL PANS



5.0L CHEVY

Part#
94130

Description:
for GM SB V8's, 1986 & older, starboard dipstick & windage tray, two piece rear main seal, replaces mercruiser #94130



18-0411 PAN GASKET



3.7L MERC

Part#
71938A1

Description:
for Mercruiser 3.7L, 224 cid, 470 - 485 4 cyl. aluminum block engine

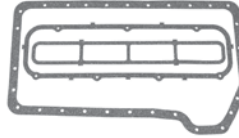

18-4366 PAN GASKET



305/350 OLD STYLE

Part#
5006166

Description:
for GM SB V8's, upto 1979, left dip, steel, two piece rear main seal, includes pan gasket



18-0153 PAN GASKET

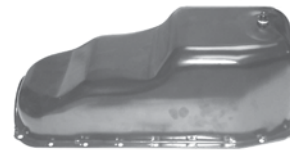

5.0 & 5.7L CHEVY

Part#
18-0613 w/o windage tray
BJM6501 w/ windage tray

Description:
GM (Chevy) SB, 1980 - 1986, 2 piece rear main seal, starb side dipstick BJM6501M replaces Mercruiser #93476 & OMC #984477



18-0411 PAN GASKET



5.0 & 5.7L

Part#
BAR55-1609

Description:
for SB Chevys 1987 * newer, starboard side dipstick, one piece rear main seal, no windage tray, steel, replaces mercruiser #809910 & 805930A1, & OMC #988222



18-1237 PAN GASKET

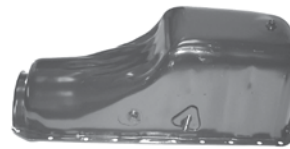

454, 350HP

Part#
18-0615

Description:
for GM BB gen. IV 1982 - 1987, steel, replaces Mercruiser 93477T & OMC 986762



FEL17985 PAN GASKET



4.3L V6

Part#
18-0616

Description:
for 4.3L V6's, 1987 & newer, one piece rear main seal with windage tray, steel, replaces Mercruiser #14244, 142445, & OMC 988234



FEL17971 PAN GASKET



454, 7.4L

Part#
18-0614

Description:
for GM BB gen V, 1988 - 1991, 1 piece rear main seal, starboard side dip stick, windage tray, replaces Mercruiser #811549, 850458, & 845668T



FEL17985 PAN GASKET