



Moeller's Full Line of Innovation.

Available in sizes to meet every need, put Moeller's comprehensive line of FDA-approved "no odor" resin, polyethylene water and waste tanks to work today.

- A vast array of permanent water and waste tank sizes ensures you the right fit for your vessel needs.
- Waste and Water tanks feature nominal wall thickness of 0.300".
- Resin meets FDA spec CFT177 1520 requirements.
- Provides standard NPT openings for vent, fill and drain.
- Tanks will not filter taste into water or emit waste odors.
- Satisfies all U.S. Coast Guard standards.
- **Exclusively manufactured by Moeller:** your leader in innovation, design and technology.

Dimensions

Follow this simple illustration to guide you in choosing the right tank for the right space.

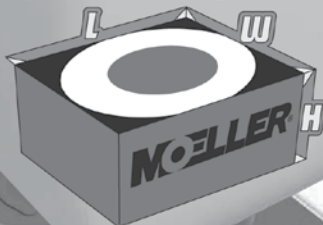

© Moeller Marine Products, Inc.

ORIGINAL EQUIPMENT
SELECT
PRODUCTS



MARINE PLUMBING & SANITATION

MOELLER WASTE & WATER TANKS



Water/Waste Tanks

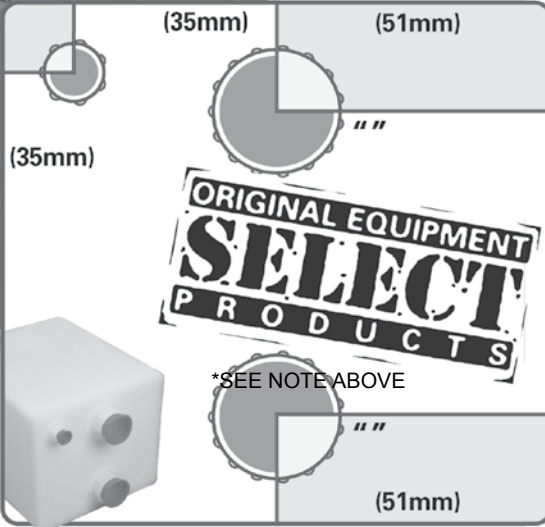

From Customer Feedback, Moeller has combined waste & water tanks in order to reduce inventory and carrying costs!

- A vast array of combo water / waste tank sizes ensures you the right fit for your vessel needs.
- Feature **nominal wall thickness of 0.300" (7.6mm)**.
- Resin meets FDA spec CFT177 1520 requirements.
- Satisfies all U.S. Coast Guard standards.
- Provides standard NPT openings for vent, fill & drain.
- Polyethylene tanks will not filter taste into water or emit waste odors.
- **Exclusively manufactured by Moeller:** your leader in innovation, design and technology.

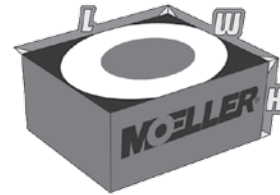

Part No.	Capacity	Dimensions (Inches)	Dimensions (Millimeters)	"A"
MOE041204	4 Gallon / 15 Litre	11.75"L x 10.25"W x 9.25"H	298mmL x 260mmW x 235mmH	5.13" 130 ^{mm}
MOE041206	5 Gallon / 19 Litre	16.00"L x 11.75"W x 8.00"H	406mmL x 298mmW x 203mmH	5.88" 149 ^{mm}
MOE041209	9 Gallon / 34 Litre	17.00"L x 13.75"W x 10.25"H	432mmL x 349mmW x 260mmH	6.88" 175 ^{mm}
MOE041215	12 Gallon / 45 Litre	24.25"L x 15.25"W x 8.75"H	616mmL x 387mmW x 222mmH	7.63" 194 ^{mm}
MOE041220	19 Gallon / 72 Litre	21.00"L x 17.00"W x 14.00"H	533mmL x 432mmW x 356mmH	8.50" 216 ^{mm}
MOE041224	23 Gallon / 87 Litre	22.50"L x 22.50"W x 12.00"H	572mmL x 572mmW x 305mmH	11.25" 286 ^{mm}
MOE041225	24 Gallon / 91 Litre	29.50"L x 16.63"W x 12.75"H	749mmL x 422mmW x 324mmH	8.31" 211 ^{mm}
MOE041229	28 Gallon / 106 Litre	23.50"L x 20.00"W x 15.50"H	597mmL x 508mmW x 394mmH	10.00" 254 ^{mm}

Pre-Installed Access Cleanout Located Top Center of Tanks Listed Below

Part No.	Capacity	Dimensions (Inches)	Dimensions (Millimeters)	"A"
MOE041230	29 Gallon / 110 Litre	28.00"L x 23.00"W x 11.50"H	711mmL x 584mmW x 292mmH	11.50" 292 ^{mm}
MOE041239	38 Gallon / 144 Litre	32.00"L x 21.50"W @ top x 19.75"W @ bottom x 14.50"H	813mmL x 546mmW @ top x 502mmW @ bottom x 368mmH	10.75" 273 ^{mm}
MOE041245	44 Gallon / 167 Litre	35.25"L x 20.88"W x 15.25"H	895mmL x 530mmW x 387mmH	10.44" 265 ^{mm}
MOE041277	76 Gallon / 288 Litre	35.62"L x 23.25"W x 22.81"H	905mmL x 591mmW x 579mmH	11.63" 295 ^{mm}

Water/Waste Tank Adapter Kits (Also for use with previous style waste only tanks)

Part No. Description
MOE041311 Straight Pipe-to-Hose Kit

Contains parts required to attach hoses to tanks: (2) 1/2 NPT x 1/2" Barb; (2) 1-1/2 NPT x 1-1/2" Barbs; Teflon Tape.



MOE041390 90° Pipe-to-Hose Kit

Contains parts required to attach hoses to tanks: (2) 1/2 NPT x 1/2" Barb; (2) 1-1/2 NPT x 1-1/2" Barbs; Teflon Tape.

MOE041336 Relocation Kit

Contains fittings required to move location of fittings for custom installations: (1) access plate, 4" I.D.; (2) 1-1/2 NPT plugs; (2) 1/2 NPT plug; (2) 5/8" plastic thru-hull fitting for supply or vent; (2) 1-1/2 plastic thru-hull fittings for fill; (6) stainless steel screws, washers and nuts; Teflon tape.



MARINE PLUMBING & SANITATION

JOHNSON AQUA-T TOILETS & THETFORD PORTA POTTIES



MANUAL MARINE TOILET

JOHNSON PUMP



The fine finish & well thought-through design of these toilets is remarkable, Made from white porcelain, & with corrosion resistant parts throughout, This is a manual pump toilet with a compact bowl

Part#	Size	Weight
JP80-47229-01	17.7" w x 13.6" h x 16.7" d	21lbs.

PREMIUM ELECTRIC MARINE TOILETS



JOHNSON PUMP

Both toilets include a built in macerator / discharge pump, wall mount rocker switch for toilet operation

Part#	Size	Weight
Supplied with an additional water supply pump to bring in water from a thru-hull for bowl rinse & flush		
JP80-47235-01	Comfort bowl, 14.4" w x 17.9" h x 17.9" d, 12 Volt	n/a

Supplied with an solenoid for rinse & flush when attaching to existing domestic pressure water supply system		
JP80-47235-03	Comfort bowl, 14.4" w x 17.9" h x 17.9" d, 12 Volt	n/a

THETFORD PORTA POTTIE #135

THETFORD MARINE



This durable toilet is sanitary, odorless and leakproof. Plus, it's easy to clean! Bellows flush simplifies flushing fresh water to clean bowl Exclusive no-splash pour spout Removable seat & cover Built-in deodorant storage (bottle included) Hold down kit secures toilet to deck

Part#	Size	Gal.
THE25103	15-1/16" w x 12-1/8" h x 13-9/16" d	2.6

STANDARD ELECTRIC MARINE TOILETS

JOHNSON PUMP



East to install & an economical choice for electric toilets, These units have a combined pump unit for disposal & bowl filling

Part#	Size	Weight
JP80-47435-01	Compact bowl, 13.2" w x 15.4" h x 16.5" d, 12 Volt	21lbs.
JP80-47436-01	Household bowl, 14.4" w x 15.2" h x 19.3" d, 12 Volt	24lbs.

SILENT ELECTRIC MARINE TOILETS



These toilets are supplied with an additional water supply pump to bring in water from a thru-hull for bowl rinse & flush, Includes a built in macerator / discharge pump, wall mount rocker switch for toilet operation

Part#	Size	Weight
JP80-47231-01	Compact bowl, 13.2" w x 15.4" h x 16.5" d, 12 Volt	21lbs.
JP80-47232-01	Comfort bowl, 14.4" w x 15.2" h x 19.3" d, 12 Volt	24lbs.

THETFORD PORTA POTTIE #735

THETFORD MARINE



Features dependable positive locking lid latch, level gauge indicator, exclusive no-splash pour out spout, built-in storage compartment for toilet deodorant, air relief vent, and hold down brackets for secure installation. Fully self-contained hand carried, and fresh water flushed toilets fit neatly in 16-26' boats

Part#	Size	Gal.
THE25104	13-9/16" w x 12-1/8" h x 15-1/16" d	2.6



MARINE PLUMBING & SANITATION

MACERATOR PUMPS, VALVES, & WATER HEATERS

Seaward Products

WATER HEATERS



S SERIES



F SERIES

Seaward Water Heaters offer a combination electric water heater/ heat exchanger which allows you to heat water at dock side with 110/120V AC power or while underway using engine heat, Inner tanks & hold down brackets are made from Alcoa Alclad aluminum alloy, Hold down brackets welded to inner tank, UL (120V models) approved, Temperature pressure relief valve, Magnesium anodes available, Large 1/2-inch drain valve, Ignition protected, T & P drain tube included, available in Marine Galvanized Steel or Stainless Steel Exteriors

Part#	Capacity	Finish	Size
Rear Mount Heat Exchanger "S series"			
Fittings for the heat exchanger are located on the BACK			

SEWS600	6 gal.	Galv. Steel	13"w x 19"d x 13"h
SEWS700	6 gal.	Stain. Steel	13"w x 19"d x 13"h
SEWS1200	11 gal.	Stain. Steel	16"w x 22"d x 16"h

Front Mount Heat Exchanger "F series"			
Fittings for the heat exchanger are located on the FRONT			

SEWF600	6 gal.	Galv. Steel	13"w x 19"d x 13"h
SEWF700	6 gal.	Stain. Steel	13"w x 19"d x 13"h
SEWF1200	11 gal.	Stain. Steel	16"w x 19"d x 16"h

Seaward Products

PRESSURE RELIEF VALVE



Part#	Description:
SEW73127	1/2" MPT, 150 psi @ 210°
RARWH3	3/4" MPT, 150 psi @ 210°



Part#	Description:
SEW74031	Threaded 120V, 1500 watt element



Part#	Description:
SEW73129	Replacement thermostat, for 120 or 240 volt



WATER HEATERS



Atwood water heaters not only heat water quickly & efficiently, but also deliver every possible ounce of usable hot water from the tank. Atwood water heaters perform reliably, assuring customer satisfaction & full use of the hot water benefits designed in your pleasure boat, The cubic shape & lightweight aluminum-alloy tank offers greater flexibility for water heater location in floor plans, these are 120 Volt models

Part#	Cap.	Finish	Size
ATW93891	6 gal.	Painted	13"w x 15-3/4"d x 13"h
ATW94610	6 gal.	Stain. Steel	13"w x 15-3/4"d x 13"h
ATW93882	11 gal.	Painted	15.75"w x 15.75"d x 15.75"h
ATW94550	11 gal.	Stain. Steel	15.75"w x 15.75"d x 15.75"h

ACCESSORIES FOR ATWOOD WATER HEATERS



Part#	Description:
ATW90037	Thermostat assembly, 120V
ATW91580	Heating element, 1400-WATT, 120V element
ATW91604	1/2"-MPT Pressure relief valve, 150 PSI



Designed for installation in waste discharge & bilge pump out systems, When installed, the waste can be pumped directly into a holding tank or diverted to an overboard discharge fitting

Part#	Description:
JP81-47238-01	"Y" Waste Valve, 1-1/2 Inlets & Outlets



The ideal answer to simple holding tank pumps-outs, The macerator grinds waste into small particles so it easily passes through the pumps 1" hose barbed discharge port, inlet is 1-1/2" NPT & hose combo, flow rate of 10 GPH, run dry capability

Part#	Description:
SUR3200-001	12V, Macerator Pump

MARINE PLUMBING & SANITATION

FAUCETS & SHOWER HEAD FIXTURES



Basin Faucet
Made of Chrome
Plated Brass



Part#
WHCP-1832
Description:
Fit's 3/8" copper tube
or 1/2" flexible water
supply, includes "H" &
"C" buttons



Wash Down Faucet
Made of Stainless Steel

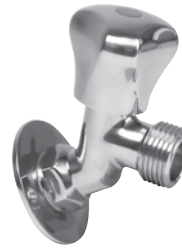

Part#
WHCP-2456C
Description:
Base Dia.: 2-3/16"
Depth: 3-3/16"
Threads: 1/2" FPT x
3/4" GHT



Washdown Faucet
Made of Chrome
Plated Brass



Part#
WHCP-2452C
Description:
Base Dia.: 1-5/8"
Threads: 1/2" FPT



Washdown Faucet
Made of Chrome
Plated Brass



Part#
WHCP-2453C
Description:
Base Dia.: 2-3/16"
Threads: 1/2" FPT



Washdown Outlet
Made of C.P. Brass



Part#
WHCP-2454C
Description:
Base Dia.: 2-3/4"
Depth: 1"
Threads: 1/2" FPT x
3/4" GHT



Water Inlet
Made of C.P. Brass



Part#
WHCP-2455C
Description:
Base Dia.: 2-3/4"
Depth: 1-1/2"
Threads: 1/2" FPT x
3/4" GHT



Shower head



Multi-featured showerhead allows you a choice
of five spray patterns (rain shower high/low -
massage w/ rain shower - massage spray

Part#	Description:
CAC43710	Chrome
CAC43711	White
CAC43712	Off White



Shower head Kit w/ Wall
Mount & 60" Flex Hose



Part#	Description:
CAC43713	Chrome
CAC43714	White
CAC43715	Off White