

MARINE ZINC ANODES

MERCURY & MERCURISER ZINC ANODES

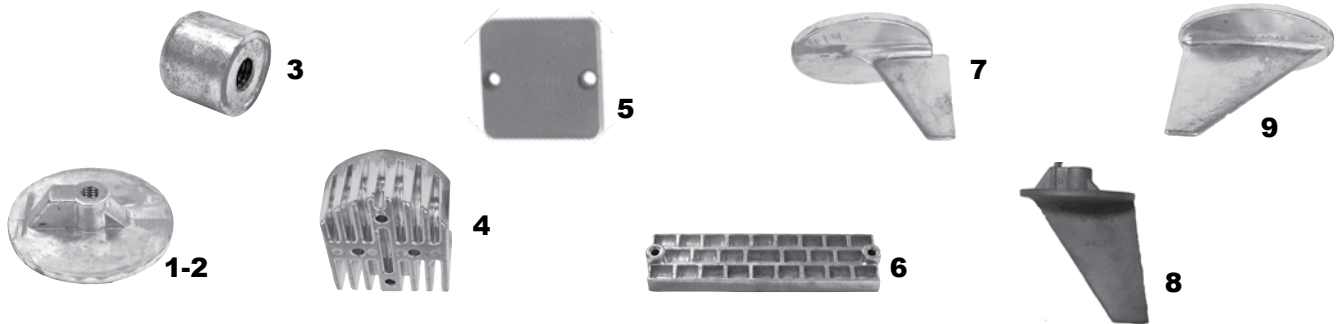

ZINC ANODES FOR MERCURY / MERCURISER OUTDRIVES & OUTBOARDS



Ref#	Part#	Description:
1	LLM76214	Flat trim plate, Alpha I, Gen II, All bravo & Verado
2	ZIN76214-4	Flat trim plate, Bravo III 2004 - present (no threads)
3	LLM55989	Nut / Ram transom bolt
4	LLM43994A	Transom, Alpha I
5	LLM34762	TRS transom
6	LLM43396	Mercury outboards 70 thru 200hp
7	LLM46399	Trim tab offset / high performance S/S props
8	ZIN34127	Trim tab, extra long
9	LLM31640	Trim tab, Alpha I, Alpha I Gen II

ZINC ANODES FOR MERCURY / MERCURISER OUTDRIVES & OUTBOARDS

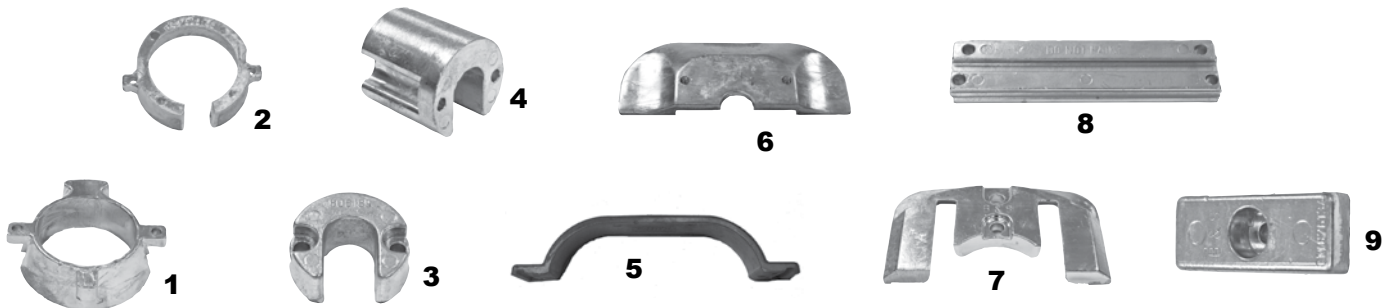

Ref#	Part#	Description:
1	ZIN806105	Carrier ring, Alpha I Gen II
2	ZIN806188	Carrier, Bravo I
3	ZIN806189	Trim cylinder, Alpha I Gen II
4	ZIN806190	Trim Cylinder, Bravo I, II, III
5	LLM89949	Mercury & Mariner outboard plate zinc
6	LLM821629	Cavitation plate, Alpha I 1991 & newer
7	LLM821630	Cavitation plate, Bravo I, II, III
8	LLM818298	Bar, Mercury & Mariner outboards including Verado V4
9	ZIN826134	Wedge, verado V4 & V6, Most Mercury outboards



MARINE ZINC ANODES

OMC, EVINRUDE, JOHNSON, & VOLVO-PENTA ZINC ANODES

ZINC ANODES FOR OMC - ENVINRUDE - JOHNSON OUTBOARDS & OUTDRIVES

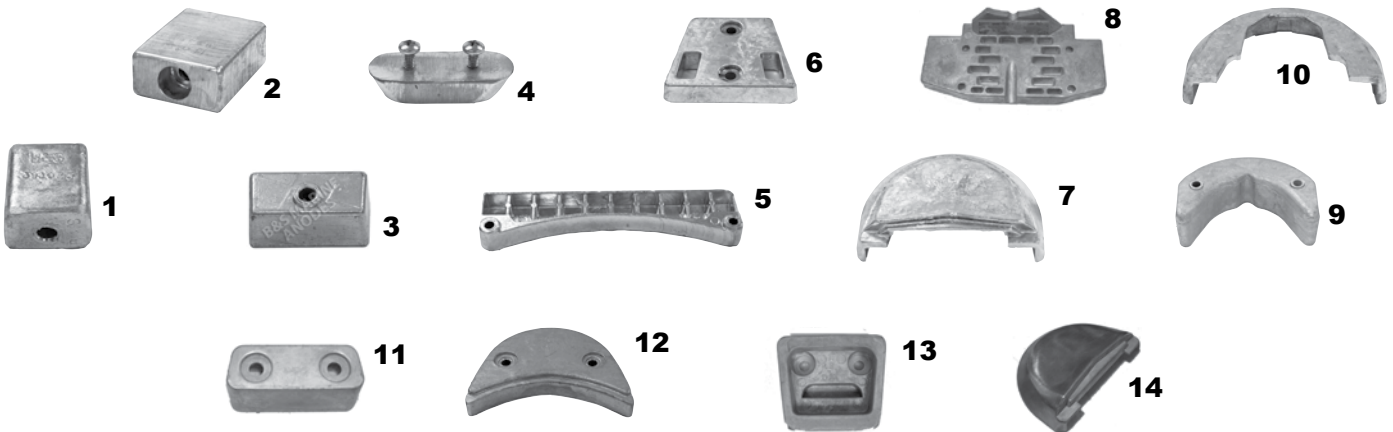

Ref#	Part#	Description:
1	LLM393023	Ice Cube, Cobra 1984 - 1996, J/E 90 - 225hp 1991 & newer
2	LLM433458	Long ice cube
3	LLM397768	Wide ice cube, Cobra 1987 - 1989
4	LLM173029	Cavitation plate, ALL outboards, threaded
5	LLM367	OMC transom zinc
6	ZIN984547	Transom plate, Cobra 1986 - 1989
7	LLM984513	Full horseshoe, lower gear case, Cobra 1987 - 1993
8	ZIN982438	Intermediate housing, electric shift 400 & 800
9	LLM983494	Open horseshoe, lower gear case, Cobra 1984 - 1986
10	LLM392462	Lower gear case, 50 - 75hp 1982 - present
11	ZIN986158	Tansom plate, Cobra 1990 - 1993
12	LLM392123	Cavitation plate, outboards
13	ZIN3854130	Drive plate, SX
14	ZIN3855411	Cavitation plate, SX

ZINC ANODES FOR VOLVO PENTA OUTDRIVES

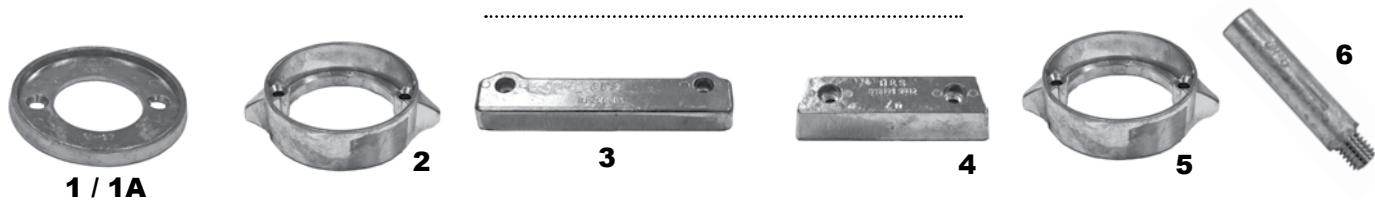

Ref#	Part#	Description:
1	ZINV16	Outdrive ring, behind propeller 200
1A	LLMV17	Outdrive ring, behind propeller 250 - 270
2	LLMV18	Outdrive ring, behind propeller 270 - 280
3	LLM832598	Transom plate, 250 - 280
4	LLM852835	Transom plate, 290 Single & Duo
5	ZIN875821	Duo-prop, behind propeller 290DP - 280DP
6	LLMPZ12	Pencil zinc Only, #838929-8

MARINE ZINC ANODES

YAMAHA ZINC ANODES



ZINC ANODES FOR YAMAHA OUTBOARDS

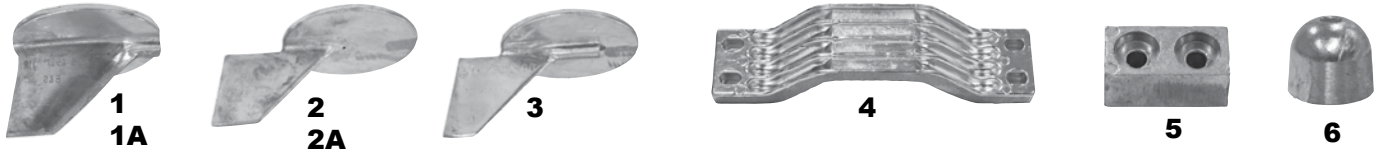

Ref#	Part#	Description:
1	LLM6E5-45371-01	Trim tab, Right hand, V4, 90 - 200hp
1A	LLM6L6-45371-00	Trim tab, Left hand, V4, 90 - 200hp
2	LLM688-45371-02	Trim tab, 40 - 90hp
3	LLM6J9-45371-00	Trim tab, Right hand, V6 150 - 200hp
3A	LLM6K1-45371-01	Trim tab, Left hand, V6 150 - 200hp
4	LLM6G5-45251-01	Bracket, V6 115 - 300hp
5	LLM6E5-45251	Button, 115 - 200hp
6	LLM688-45251	Button, 40 - 90hp

ZINC ANODES FOR HULLS

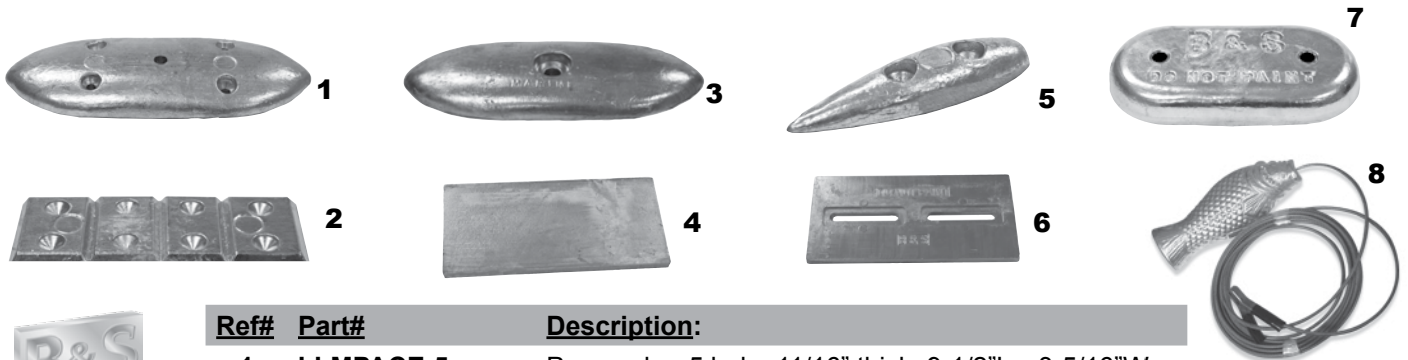

Ref#	Part#	Description:
1	LLMPACE-5	Pacemaker 5 hole, 11/16" thick, 9-1/2"L x 3-5/16"W
2	LLMA40	Hull zinc, 4 part
3	LLMPACE-1	Pacemaker 1 hole, 3/4" thick, 9-1/2"L x 3-7/16"W
4	LLMPZP2	Plate zinc, NO hole, 1/2" thick, 12"L x 6"W
5	LLMT22	Tear drop, 3/4" thick, 5-3/16"L x 1-7/16"W
6	LLMZP3	Plate zinc, Slotted, 1/2" thick, 12"L x 6"W
7	LLMB12	B-12, Sea Ray, 1-1/8" thick, 8-9/16"L x 4-1/4"W
8	ZINGP1	Guppy, Over the side zinc

ZINC ANODES FOR STRAINERS & ICE EATERS



Ref#	Part#	Description:
1	LLMBSSZ	B&S strainer zinc, 1-1/2" x 3-13/16", c-c 1-1/2"
2	LLMDOKA	Doka Strainer zinc, 1-3/16" x 3-1/4", c-c 1-7/8"
3	ICE900000	Ice eater zinc, 1/2"
4	TAY41896P	D-Icer anode, 9/16"



MARINE ZINC ANODES

PENCIL, RUDDER, SHAFT & DONUT COLLAR ZINC ANODES

PENCIL ZINCS

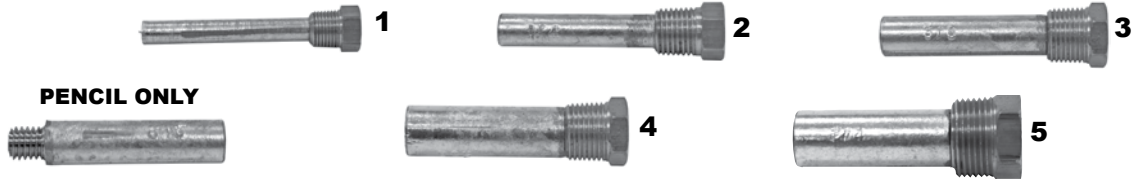

PENCIL ONLY

Part#	Description:
LLMPZ18	1/8" pencil zinc only
LLMPZ14	1/4" pencil zinc only
LLMPZ38	3/8" pencil zinc only
LLMPZ12	1/2" pencil zinc only
LLMPZ34-2	3/4" x 2" pencil zinc only
LLMPZ34-3	3/4" x 3" pencil zinc only

Ref#	Part#	Description:
1	LLMPZ18C	1/8" pencil zinc & plug
2	LLMPZ14C	1/4" pencil zinc & plug
3	LLMPZ38C	3/8" pencil zinc & plug
4	LLMPZ12C	1/2" pencil zinc & plug
5	LLMPZ34-2C	3/4" x 2" pencil zinc & plug
5a	LLMPZ34-3C	3/4" x 3" pencil zinc & plug

RUDDER BUTTON ZINCS

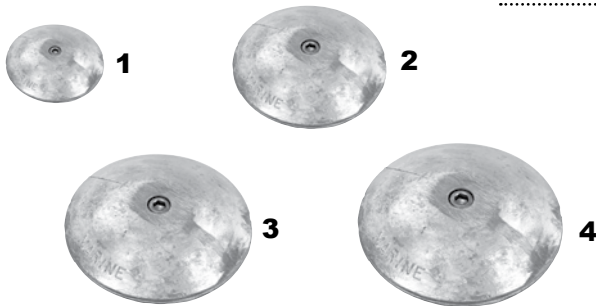

Ref#	Part#	Description:
1	LLMR2	2" rudder button
2	LLMR3	3" rudder button
3	LLMR4	4" rudder button
4	LLMR5	5" rudder button

MIL-SPEC STREAMLINED COLLAR ZINCS

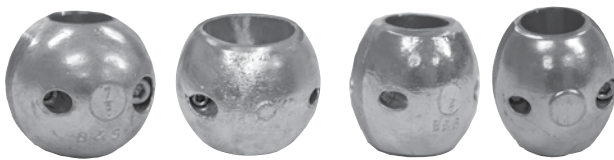

Part#	Description:
LLMX1	3/4" shaft
LLMX2	7/8" shaft
LLMX3	1" shaft
LLMX4	1-1/8" shaft
LLMX5-STD	1-1/4" shaft - standard
LLMX5-HD	1-1/4" shaft - heavy duty
LLMX6	1-3/8" shaft
LLMX7	1-1/2" shaft
LLMX8	1-3/4" shaft
LLMX9	2" shaft
LLMX10-HD	2-1/4" shaft - heavy duty

DONUT COLLAR ZINCS

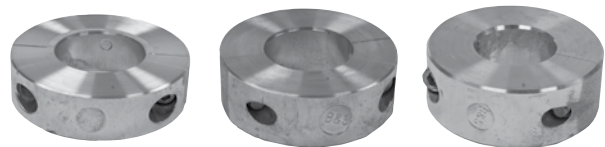

Part#	Description:
LLMC3	1" collar, 2-1/2" O.D. x 1" W
LLMC4	1-1/8" collar, 2-1/2" O.D. x 1-1/4" W
LLMC5	1-1/4" collar, 2-1/2" O.D. x 1-1/4" W
LLMC6	1-3/8" collar, 3" O.D. x 1" W
LLMC7	1-1/2" collar, 3" O.D. x 1" W
LLMC8	1-3/4" collar, 3-1/2" O.D. x 1-1/8" W
LLMCP	2" collar, 4" O.D. x 1-1/4" W
LLMCQ	2-1/2" collar, 5" O.D. x 1-1/4" W

MARINE ALUMINUM ANODES

PERFORMANCE METALS MARINE ALUMINUM ANODES



Part#
PRF10108A
Description:
R/MR/Alpha One Gen. 1
Anode Kit - 1983 - 1990
Serial #s 6225577 -
OD469828



Part#
PRF10061A
Description:
All Bravo 2's & early Bravo 3's
without drilled prop shaft for
anode

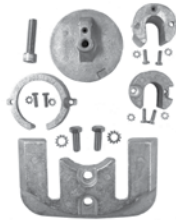

Part#
PRF10060A
Description:
Bravo One - 1996 to present.
Serial #s OB730000 and up



Part#
PRF10165A
Description:
Bravo 3, Design Two Anode
Kit. Use on Bravo 3's produced
since 2004 - ser# OM100001
and up



Part#
PRF10059A
Description:
Alpha One Gen. 2 - 1991 to
present. Serial #s OD469859
and up



Part#
PRF00041A
Description:
Alpha One Gen. II Cavitation
Plate



Part#
PRF00047A
Description:
Bravo I, II, & III
Trim Cylinder Anode



Part#
PRF00163A
Description:
Bravo 3 models 2004 &
later Prop Anode



Part#
PRF00042A
Description:
Alpha One Gen. II Trim
Cylinder Anode



Part#
PRF00048A
Description:
Bravo I Bearing
Carrier



Part#
PRF00268A
Description:
Bravo 3 models 2004
& later, Trim Tab Anode
Flat (No Thread)



Part#
PRF00043A
Description:
Alpha One Gen. II
Bearing Carrier



Part#
PRF00049A
Description:
Alpha One, Gen. I, II, III,
Bravo I, II, III Trim Tab
Anode - Flat



Part#
PRFC0750A
Description:
Collar - Streamlined
3/4" Shaft



Part#
PRF00044A
Description:
Alpha One Gen. I & II
Trim Tab Anode

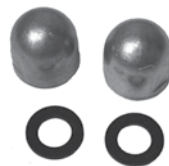

Part#
PRF00050A
Description:
Alpha One, Gen. I, II,
Gimbal Housing Bolt
Headnut



Part#
PRFHBNTA
Description:
Bennett Trim Tab
Anode (2 per kit)



Part#
PRF00045A
Description:
Alpha One Gen. I & II Gimbal
Housing Block



Part#
PRF00051A
Description:
35-300 hp o/b's & Force
90 & 120 hp o/b's ('95 to
present)



Part#
PRFHBSLA
Description:
Bossler Strainer Anode



Part#
PRF00046A
Description:
Bravo I, II, & III
Cavitation Plate

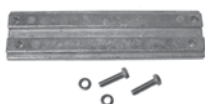

Part#
PRF00052A
Description:
Merc outboard Anode



Part#
PRFR2813A
Description:
2-13/16" Rudder
Anode
Part#
PRFR3750A
Description:
3-3/4" Rudder
Anode